



Free Spirit

Woodland Dreaming Quilt

Featuring Land Art by Odile Bailleoul

The colors, flora and fauna of the woodlands overlap into a beautiful dream in this quilt by Odile Bailleoul, featuring her Land Art fabric line.

Collection:	Land Art by Odile Bailleoul
Technique:	Piecing, Appliqué (machine or hand)
Skill Level:	Advanced Beginner
Finished Size:	42½" x 58" (107.95cm x 147.32cm)

All possible care has been taken to assure the accuracy of this pattern. We are not responsible for printing errors or the manner in which individual work varies. Please read the instructions carefully before starting this project. If kitting it is recommended a sample is made to confirm accuracy.

Project designed by Odile Bailloeul

Tech edited by Alison M. Schmidt

Fabric Requirements

Fussy-cut fabrics highlighted below: You may need more or less yardage than the amount listed, depending on the placement of the fussy-cut motif in relation to where in the design repeat your particular cut yardage begins. Before specifying a cut amount to purchase at a fabric shop, it's best to know what pieces need to be fussy cut and check the placement in person.

DESIGN	COLOR	ARTICLE CODE	YARDAGE
(A) Enchanted Forest	Navy	PWOB018.NAVY	1 $\frac{2}{3}$ yards (1.52m)
(B) Enchanted Forest	Rose	PWOB018.ROSE	1 $\frac{1}{8}$ yards (1.03m)
(C) Fairy Circles	Navy	PWOB019.NAVY*	1 $\frac{1}{4}$ yards (1.14m)
(D) Fairy Circles	Bleu	PWOB019.BLEU	$\frac{5}{8}$ yard (57.15cm)
(E) Jewels	Vert	PWOB020.VERT	$\frac{3}{8}$ yard (34.29cm)
(F) Jewels	Rose	PWOB020.ROSE	$\frac{1}{2}$ yard (45.72cm)
(G) Stone Flowers	Navy	PWOB024.NAVY	$\frac{1}{4}$ yard (22.86cm)
(H) Stone Flowers	Rose	PWOB024.ROSE	$\frac{3}{8}$ yard (34.29cm)
(I) Seeds	Crème	PWOB021.CREME	$\frac{1}{2}$ yard (45.72cm)
(J) Seeds	Rose	PWOB021.ROSE	$\frac{5}{8}$ yard (57.15cm)
(K) Petit Poucet	Bleu	PWOB022.BLEU	$\frac{1}{4}$ yard (22.86cm)
(L) Pollen	Crème	PWOB023.CREME	$\frac{1}{4}$ yard (22.86cm)

* includes binding

Backing (Purchased Separately)

44" (111.76cm) wide

Stone Flowers Navy PWOB024.NAVY 3 yards (2.74m)

OR

108" (274.32cm) wide 3 yards (2.74m)

Additional Requirements

- 51" x 66" (129.54cm x 167.64cm) batting
- 100% cotton thread in a color to match
- Invisible thread for machine appliqué or your preferred thread for hand appliqué
- Embroidery floss or perle cotton (optional)

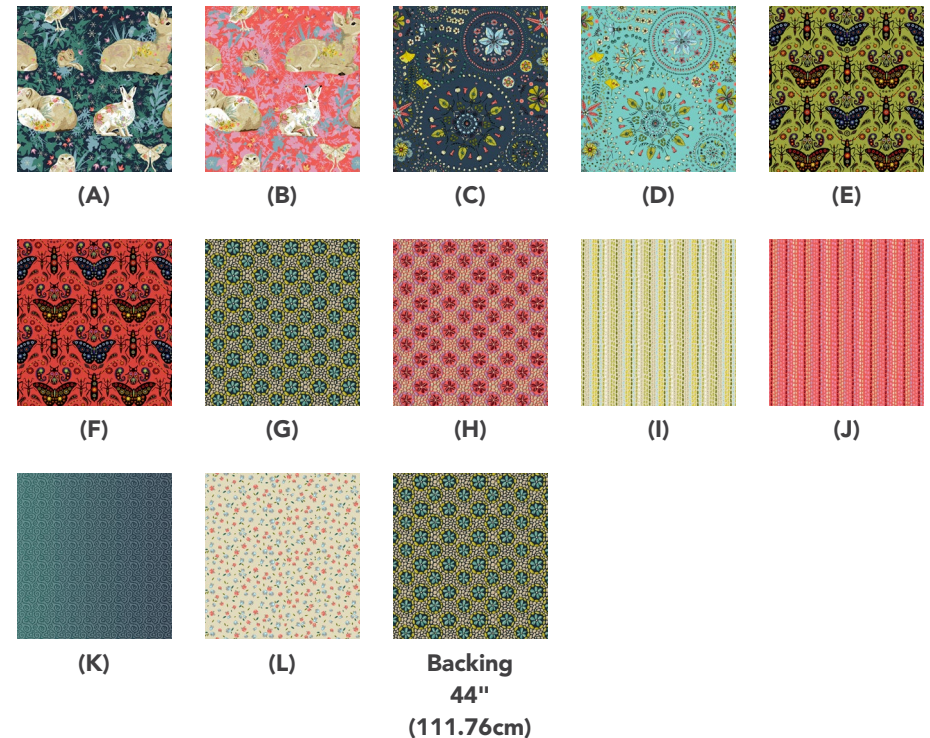

Cutting

WOF = Width of Fabric

LOF = Length of Fabric

Note: Fussy cut shape measurements are given width x height to aid in cutting. Others are listed as smaller x larger.

Label pieces with the letter/number listed as they are cut to aid in their placement when sewing.

Fabric A, fussy cut:

- (2) 15" x 11½" (38.10cm x 29.21cm) rectangles, centering over (1) left-facing and (1) right-facing deer (A1L/A1R)
- (1) 13" x 8" (33.02cm x 20.32cm) rectangle, centering over a fox (A2)
- (1) 8½" x 8" (21.59cm x 20.32cm) rectangle, centering over a rabbit (A3)
- (1) 6¼" x 9¾" (15.88cm x 24.77cm) rectangle, centering over an owl (A4)
- (1) 6" (15.24cm) square, centering over a moth (A5)
- (1) 5½" x 6" (13.97cm x 15.24cm) rectangle, centering over a moth (A6)
- (1) 5½" (13.97cm) square, centering over a right-facing chipmunk (A7)
- (1) 5¼" (13.34cm) square, centering over a left-facing chipmunk (A8)

Fabric B, fussy cut:

- (1) 8" x 9¾" (20.32cm x 24.77cm) rectangle, centering over a left-facing rabbit (B1)
- (1) 6½" x 5½" (16.51cm x 13.97cm) rectangle, centering over a moth (B2)
- (1) 5¼" (13.34cm) square, centering over a right-facing chipmunk (B3)
- (1) 4½" x 5½" (11.43cm x 13.97cm) rectangle, centering over a right-facing rabbit's face (B4)

Fabric C, cut:

- (6) 2½" x WOF (6.35cm x WOF) strips for binding
- From the remaining fabric, centering over the floral motifs, fussy cut:**
- (1) 6¾" x 7¼" (17.15cm x 18.42cm) rectangle (C1)
- (3) 6¾" (17.15cm) squares (C2)
- (1) 6½" (16.51cm) square (C3)
- (1) 4½" (11.43cm) square (C4)
- (1) 3½" (8.89cm) square (C5)
- (1) 3" (7.62cm) square (C6)

Fabric D, cut:

- (4) 1½" x WOF (3.81cm x WOF); sub-cut:**
- (2) 1½" x 40" (3.81cm x 101.60cm) strips (D1)
- (1) 1½" x 27" (3.81cm x 68.58cm) strip (D2)
- (1) 1½" x 15" (3.81cm x 38.10cm) strip (D3)
- (2) 1½" x 6½" (3.81cm x 16.51cm) rectangles (D4)
- (2) 1½" x 3" (3.81cm x 7.62cm) rectangles (D5)
- (1) 1¼" x WOF (3.18cm x WOF); sub-cut
- (2) 1¼" x 10" (3.18cm x 25.40cm) rectangles (D6)
- (2) 1¼" x 8" (3.18cm x 20.32cm) rectangle (D7)
- From the remaining fabric, centering over the floral motifs, fussy cut:**
- (1) 4½" (11.43cm) square (D8)
- (1) 4" (10.16cm) square (D9)
- (1) 3" (7.62cm) square (D10)

Fabric E, centering over the butterflies, fussy cut:

- (2) 13" x 3¾" (33.02cm x 9.53cm) rectangles (E1)
- (1) 5½" (13.97cm) square (E2)
- (1) 4" x 4¼" (10.16cm x 10.80cm) rectangle (E3)
- (1) 4½" (11.43cm) square (E4)
- (1) 4" (10.16cm) square (E5)

Fabric F, centering over the butterflies, fussy cut:

- (1) 22" x 3¾" (55.88cm x 9.53cm) strip (F1)
- (1) 8¾" x 6¾" (22.23cm x 17.15cm) rectangle (F2)
- (2) 8½" (21.64cm) squares (F3)
- (1) 4½" (11.43cm) square (F4)
- (1) 4" x 4½" (10.16cm x 11.43cm) rectangle (F5)

Fabric G, cut:

- (1) 2½" x WOF (6.35cm x WOF); sub-cut:**
- (1) 2½" x 13" (6.35cm x 33.02cm) strip (G1)
- (1) 2½" x 10" (6.35cm x 25.40cm) rectangle (G2)
- (1) 2½" x 5¼" (6.35cm x 13.34cm) rectangle (G3)
- (2) 2" x WOF (5.08cm x WOF); sub-cut:**
- (1) 2" x 15" (5.08cm x 38.10cm) strip (G4)
- (2) 2" x 9½" (5.08cm x 24.13cm) rectangles (G5)
- (1) 2" x 6½" (5.08cm x 16.51cm) rectangle (G6)
- (1) 2" x 5" (5.08cm x 12.70cm) rectangle (G7)
- (1) 1½" x WOF (3.81cm x WOF); sub-cut (1) 1½" x 15" (3.81cm x 38.10cm) strip (G8)

Fabric H, cut:

(1) 4½" x WOF (11.43cm x WOF); sub-cut:

- (1) 4½" x 5" (11.43cm x 12.70cm) rectangle (H1)
- (1) 4" x 11¾" (10.16cm x 29.85cm) strip (H2)
- (1) 3½" x 4" (8.89cm x 10.16cm) rectangle (H3)
- (2) 3" x 4" (7.62cm x 10.16cm) rectangle (H4)
- (1) 1¾" x 11¾" (4.45cm x 29.85cm) strip (H5)

(1) 2½" x WOF (6.35cm x WOF); sub-cut:

- (1) 2½" x 7½" (6.35cm x 19.05cm) rectangle (H6)
- (1) 2½" x 6" (6.35cm x 15.24cm) rectangle (H7)
- (1) 2½" x 4" (6.35cm x 10.16cm) rectangle (H8)
- (1) 1¾" x 2¾" (4.45cm x 6.99cm) rectangle (H9)
- (2) 1½" x 6¼" (3.81cm x 15.88cm) rectangles (H10)

(1) 1½" x WOF (3.81cm x WOF); sub-cut:

- (2) 1½" x 8½" (3.81cm x 21.59cm) rectangles (H11)
- (2) 1½" x 6½" (3.81cm x 16.51cm) rectangles (H12)
- (1) 1½" x 4½" (3.81cm x 11.43cm) rectangle (H13)
- (1) 1½" x 4" (3.81cm x 10.16cm) rectangle (H14)
- (1) 1½" x 2" (3.81cm x 5.08cm) rectangle (H15)

Fabric I, cut:

- (7) 1" x LOF (2.54cm x WOF)

From the remainingwidth of fabric, cut:

(1) 9½" x WOF (24.13cm x WOF); sub-cut:

- (1) 3" x 9½" (7.62cm x 24.13cm) rectangle (I1)
- (1) 3" x 7½" (7.62cm x 19.05cm) rectangle (I2)
- (2) 3" x 7" (7.62cm x 17.18cm) rectangles (I3)
- (1) 2½" x 6" (6.35cm x 15.24cm) rectangle (I4)
- (1) 3¼" x 5½" (9.53cm x 13.97cm) rectangle (I5)
- (1) 3¼" x 4" (9.53cm x 10.16cm) rectangle (I6)
- (1) 2½" x 2" (6.35cm x 5.08cm) rectangle (I7)

Fabric J, cut:

(1) 2¾" x LOF (6.99cm x WOF); sub-cut:

- (1) 2¾" x 22" (6.99cm x 55.88cm) strip (J1)

From the remainingwidth of fabric, cut:

(1) 9¾" x WOF (24.77cm x WOF); sub-cut:

- (1) 5½" x 9¾" (13.97cm x 24.77cm) rectangle (J2)
- (1) 8½" x 4½" (21.59cm x 11.43cm) rectangle (J3)
- (1) 4" x 8¼" (10.16cm x 20.96cm) rectangle (J4)
- (1) 7½" x 3" (19.05cm x 7.62cm) rectangle (J5)
- (1) 15" x 3½" (38.10cm x 8.89cm) strip (J6)

(1) 5¾" x WOF (14.61cm x WOF); sub-cut:

- (2) ¾" x 5¾" (1.91cm x 14.61cm) strips (J7)
- (2) ¾" x 5¼" (1.91cm x 13.34cm) strips (J8)
- (1) 3½" x 4" (8.89cm x 10.16cm) rectangle (J9)
- (1) 3" x 4" (7.62cm x 10.16cm) rectangle (J10)
- (1) 4½" x 3¼" (11.43cm x 9.53cm) rectangle (J11)
- (1) 7½" x 2½" (19.05cm x 6.35cm) rectangle (J12)
- (1) 6" x 2½" (15.24cm x 6.35cm) rectangle (J13)

(1) 2½" x WOF (6.35cm x WOF); sub-cut:

- (2) 2½" x 5½" (6.35cm x 13.97cm) rectangles (J14)
- (2) 2" x 8½" (5.08cm x 21.59cm) rectangles (J15)

Fabric K, cut:

(1) 3¼" x WOF (9.53cm x WOF); sub-cut:

- (1) 3¼" x 11½" (9.53cm x 29.21cm) rectangle (K1)
- (1) 3¼" x 7¼" (9.53cm x 18.42cm) rectangle (K2)
- (1) 2" x 3¼" (5.08cm x 9.53cm) (K3)
- (1) 1¾" x 2¾" (4.45cm x 6.99cm) rectangle (K4)
- (1) 2½" x 7" (6.35cm x 17.78cm) rectangle (K5)
- (1) 2½" x 4½" (6.35cm x 11.43cm) rectangle and (K6)
- (1) 2½" (6.35cm) square (K7)

(2) 1½" x WOF (3.81cm x WOF); sub-cut:

- (1) 1½" x 15" (3.81cm x 38.10cm) strip (K8)
- (2) 1½" x 8" (3.81cm x 20.32cm) rectangles (K9)
- (2) 1½" x 7½" (3.81cm x 19.05cm) rectangles (K10)
- (2) 1½" x 5½" (3.81cm x 13.97cm) rectangles (K11)
- (1) 1½" x 4" (3.81cm x 10.16cm) rectangle (K12)

Fabric L, cut:

(1) 3¼" x WOF (9.53cm x WOF); sub-cut:

- (1) 3¼" x 4" (9.53cm x 10.16cm) rectangle (L1)
- (2) 1¾" x 4½" (4.45cm x 11.43cm) rectangles (L2)
- (1) 1¾" x 4¼" (4.45cm x 10.80cm) rectangle (L3)
- (1) 1½" x 2" (3.81cm x 5.08cm) rectangle (L4)
- (2) 1¼" x 6¾" (3.18cm x 17.15cm) rectangles (L5)

(1) 1¼" x WOF (3.18cm x WOF); sub-cut:

- (2) 1¼" x 5¼" (3.18cm x 13.34cm) rectangles (L6)
- (2) 1" x 6¾" (2.54cm x 17.15cm) rectangles (L7)
- (2) 1" x 5¾" (2.54cm x 14.61cm) rectangles (L8)

Instructions

- All seam allowances are $\frac{1}{4}$ " (.64cm)* and pieces are sewn right sides together. Press seam allowances open unless otherwise stated. Label Units as they are made. Unit/ Panel sizes are listed width x height and include seam allowance.
- *It is important to sew with an accurate seam allowance here as each seam loses a small amount to the thread in the seam and the fold of the cloth. Therefore, the distance the seam is from the edge of the cloth is very slightly less than $\frac{1}{4}$ ", what is often called a 'scant quarter inch'. Since these units have differing quantities of seams, if your seam allowance is not accurate, your blocks may not end up the stated size and may not fit together perfectly.
- To test and set your seam allowance, cut from scraps 3 same-size pieces, such as $1\frac{1}{2}$ " x 4" (3.81cm x 10.16cm). Sew the 3 pieces together side by side, press as directed in the pattern, and then measure the center piece from seam to seam. It should be exactly $\frac{1}{2}$ " smaller than the cut width. If smaller, your seam allowance is too large. If larger, your seam allowance is too small. Adjust your needle position and/or seam guide and test again until it is accurate.

Appliqué

Appliqué is used to create the layered look of this quilt. Appliqué pieces will be added both as each panel is sewn and after the panels are sewn together.

For machine appliqué: Press the $\frac{1}{4}$ " (.64cm) seam allowance to the wrong side to finish the edges. Place the appliqué piece, right side up, as indicated in the instructions and pin in place. Edgestitch by machine, using invisible thread, around the appliqué piece.

For hand appliqué: Repeat as above, but use your preferred hand sewing thread and hand stitch in place.

Center Panel

- Sew the B2 moth rectangle to the left side of the E2 square. Sew the K1 rectangle to the bottom, then the J4 rectangle to the right side to complete Unit 1 (15" x 8 $\frac{1}{4}$ " (38.10cm x 20.96cm)). (**Fig. 1**)

Fig. 1

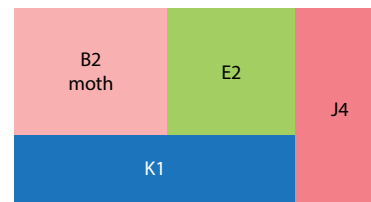

Unit 1
15" wide x 8 $\frac{1}{4}$ " high
(38.10cm x 20.96cm)

- Sew a K9 rectangle to the left and right sides of the A2 fox rectangle. Sew the K8 strip to the bottom to complete Unit 2 (15" x 9" (38.10cm x 22.86cm)). (**Fig. 2**)

Fig. 2

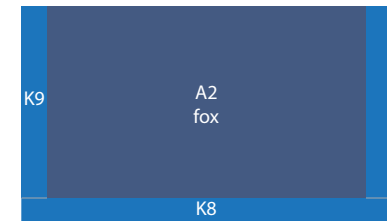

Unit 2
15" wide x 9" high
(38.10cm x 22.86cm)

- Sew a C2 square to the left side of the F2 rectangle. Sew the J6 strip to the bottom, followed by the G4 strip. Appliqué the D8 square, $2\frac{3}{8}$ " (6.03cm) from the right and $3\frac{1}{2}$ " (8.89cm) from the top raw edges to complete Unit 3 (15" x 11 $\frac{1}{4}$ " (38.10cm x 28.58cm)). (**Fig. 3**)

Fig. 3

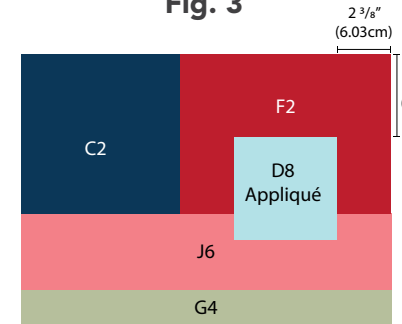

Unit 3
15" wide x 11 $\frac{1}{4}$ " high
(38.10cm x 28.58cm)

4. Sew together, top to bottom, in the order given, the A1L left-facing deer rectangle, Unit 1, Unit 2, Unit 3, the A1R right-facing deer rectangle, and the D3 strip, to complete the 15" x 50½" (38.10cm x 128.27cm) Center Panel. (**Fig. 4**)

Fig. 4

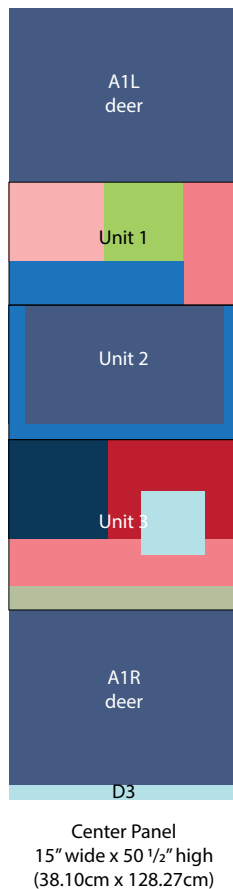

Left Panel

5. Sew a K11 rectangle to the left and right sides of the A7 right-facing chipmunk square. Sew a K10 rectangle to the top and bottom.
6. Sew the H4 and J10 rectangles together, along the short ends, and sew to the left side of the chipmunk unit. Repeat to sew the H3 and J9 rectangles to the right side. Sew the J12 rectangle to the left side of the H7 rectangle and sew to the top of the chipmunk unit. Repeat to sew the H6 rectangle and J13 rectangle to the bottom to complete Unit 4 (13" x 11½" (33.02cm x 29.21cm)). (**Fig. 5**)

Fig. 5

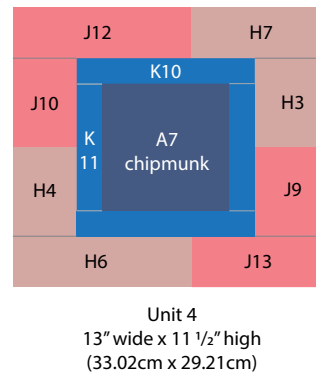

7. Sew the J3 rectangle to the left side of the H1 rectangle. Sew this section to the bottom of (1) E1 rectangle to complete Unit 5 (13" x 7¾" (33.02cm x 19.69cm)). (**Fig. 6**)

Fig. 6

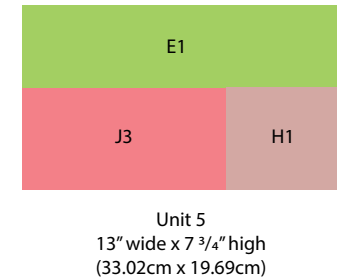

8. Sew a D7 rectangle to the left and right sides of the A3 rabbit rectangle. Sew a D6 rectangle to the top and bottom.

9. Sew a G5 rectangle to the left and right sides of the rabbit unit. Sew the G6 rectangle, I7 rectangle and G7 rectangle together end to end and sew to the top of the rabbit unit. Sew the G1 strip to the bottom to complete Unit 6 (13" (33.02cm) square). (**Fig. 7**)

Fig. 7

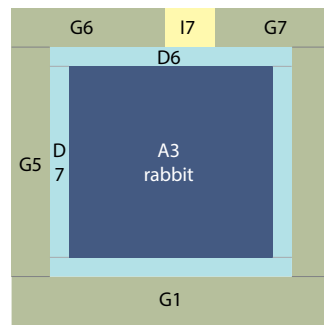

Unit 6
13" wide x 13" high
(33.02cm x 33.02cm)

10. Sew an L6 rectangle to the left and right sides of the B3 chipmunk square. Sew an L5 rectangle to the top and bottom. (**Fig. 8**)

Fig. 8

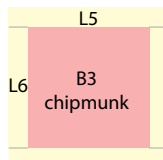

11. Sew the L3 rectangle to the left side of the E3 rectangle. Sew the H15 rectangle to the bottom of the K3 rectangle and then add to the right side of the L/E unit. Sew the K4 rectangle to the right end of (1) L2 rectangle and sew to the top of the unit. Repeat with the remaining L2 rectangle and the H9 rectangle and add to the bottom of the unit. (**Fig. 9**)

Fig. 9

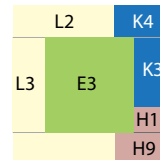

12. Sew the Step 10 unit to the left side of the Step 11 unit to complete Unit 7 (13" x 6 3/4" (33.02cm x 17.16cm)). (**Fig. 10**)

Fig. 10

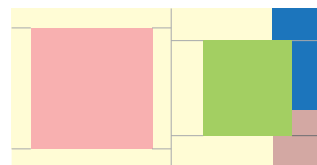

Unit 7
13" wide x 6 3/4" high
(33.02cm x 17.16cm)

13. Sew a J14 rectangle to the left and right sides of the B4 rabbit rectangle. Sew a J15 rectangle to the top and bottom. Sew (1) D5 rectangle to the end of the I2 rectangle and add to the top of the rabbit unit. (**Fig. 11**)

Fig. 11

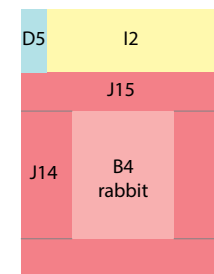

14. Sew the K7 square to the top of (1) H8 rectangle and sew to the right edge of the I4 rectangle. Add the pieced section to the bottom of the F4 square. Sew the G2 rectangle to the left side of the pieced section, then add a D4 rectangle to the bottom. (**Fig. 12**)

Fig. 12

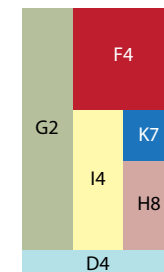

- 15.** Sew the Step 13 unit to the left side of the Step 14 unit to complete Unit 8 (14½" x 11" (36.83cm x 27.94cm)). (**Fig. 13**)

Fig. 13

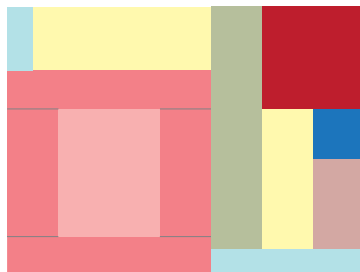

Unit 8
14 ½" wide x 11" high
(36.83cm x 27.94cm)

- 16.** Sew together (5) 1" (2.54cm) **Fabric I** x LOF strips end to end. Cut (2) 1" x 40" (2.54cm x 101.6cm) lengths. Set aside 1. Sew an H4 rectangle to the end of the I1 rectangle.

- 17.** Sew together, top to bottom, in the order given, the H/I unit, Unit 4, Unit 5, Unit 6 and Unit 7. Sew a 1" x 40" (2.54cm x 101.6cm) **Fabric I** length, then a D1 strip, to the left side of the column. Finally sew Unit 8 to the bottom to complete the Left Panel (14½" x 50½" (27.94cm x 128.27cm)). (**Fig. 14**)

Fig. 14

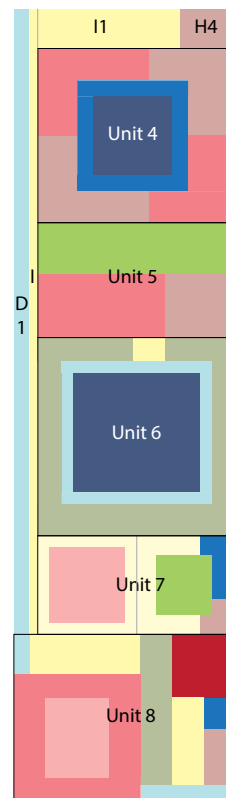

Left Panel
14 ½" wide x 50 ½" high
(27.94cm x 128.27cm)

Right Panel

- 18.** Sew the K2 rectangle to the left side of the C1 rectangle. Sew the L1 rectangle to the top of the F5 rectangle and then add to the right side of the K/C unit. Sew together the I5, J11, and I6 rectangles end to end and add to the bottom of the unit to complete Unit 9 (13" x 10" (33.02cm x 25.40cm)). (**Fig. 15**)

Fig. 15

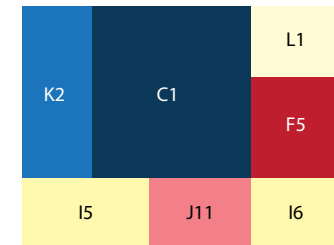

Unit 9
13" wide x 10" high
(33.02cm x 25.40cm)

19. Sew the J2 rectangle to the left side of the B1 rabbit rectangle. Sew the remaining E1 rectangle to the bottom to complete Unit 10 (13" (33.02cm) square). (**Fig. 16**)

Fig. 16

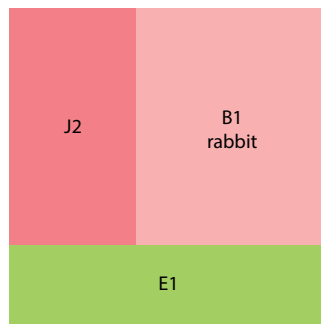

Unit 10
13" wide x 13" high
(33.02cm x 33.02cm)

20. Sew an H10 rectangle to the top and bottom of the A4 owl rectangle. Sew an H5 strip to the left side and an H2 strip to the right side of the owl unit. Sew the G3 rectangle to the bottom of the K5 rectangle and add to the right side of the owl unit. Appliqué the C5 square $\frac{3}{4}$ " (1.91cm) from the right and $1\frac{1}{4}$ " (3.18cm) from the bottom edges to complete Unit 11 (13" x $11\frac{3}{4}$ " (33.02cm x 29.85cm)). (**Fig. 17**)

Fig. 17

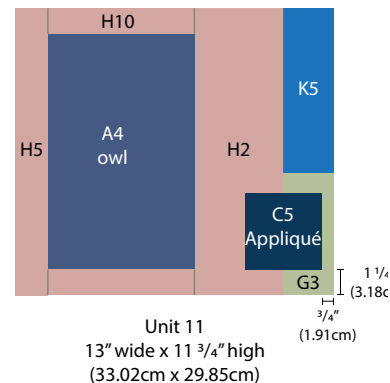

Unit 11
13" wide x $11\frac{3}{4}$ " high
(33.02cm x 29.85cm)

21. Sew a J8 strip to the sides of the A8 chipmunk square. Sew a J7 strip to the top and bottom. Repeat to sew L8 rectangles to the sides and L7 rectangles to the top and bottom. Sew the chipmunk unit to the right side of a C2 square to complete Unit 12 (13" x $6\frac{3}{4}$ " (33.02cm x 17.15cm)). (**Fig. 18**)

Fig. 18

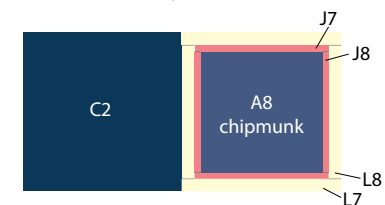

Unit 12
13" wide x $6\frac{3}{4}$ " high
(33.02cm x 17.15cm)

22. Sew the L4 rectangle to the top of the H13 rectangle. Sew the pieced section to the left side of the A6 moth rectangle, followed by a D4 rectangle at the bottom. Sew a K6 rectangle to the right edge of the E4 square and sew to the top of the moth unit. (**Fig. 19**)

Fig. 19



- 23.** Appliqué the D10 square to (1) F3 square, $1\frac{3}{4}$ " (4.45cm) from the right and bottom edges. Sew a D5 rectangle to the end of the J5 rectangle and add to the top of the F3 square. (**Fig. 20**)

Fig. 20

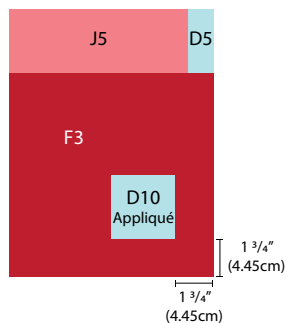

- 24.** Sew the Step 22 unit to the left side of the Step 23 unit to complete Unit 13 ($14\frac{1}{2}$ " x 11" (36.83cm x 27.94cm)). (**Fig. 21**)

Fig. 21



Unit 13
 $14\frac{1}{2}$ " wide x 11" high
(36.83cm x 27.94cm)

- 25.** Sew together, top to bottom, in the order given, Unit 9, Unit 10, Unit 11 and Unit 12. Sew the remaining 1" x 40" (2.54cm x 101.6cm) **Fabric I** length from Step 16 to the right side of the column, followed by a D1 strip. Finally sew Unit 13 to the bottom to complete the Right Panel ($14\frac{1}{2}$ " x $50\frac{1}{2}$ " (27.94cm x 128.27cm)). (**Fig. 22**)

Fig. 22

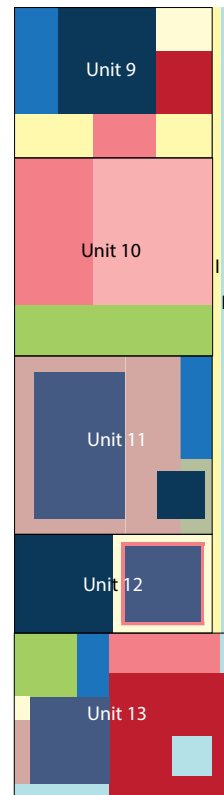

Right Panel
 $14\frac{1}{2}$ " wide x $50\frac{1}{2}$ " high
(27.94cm x 128.27cm)

Top Panel

- 26.** Sew together the (2) remaining 1" (2.54cm) **Fabric I** x LOF strips end to end. Cut (1) 1" x 27" (2.54cm x 68.58cm) length. Sew to the bottom of the D2 strip.
- 27.** Sew the J1 strip to the top of the F1 strip. Sew together the H14 rectangle, G8 strip and K12 rectangle end to end and add to the bottom of the J/F unit. Sew an I3 rectangle to each end. Sew the I/D unit from Step 26 to the top. Appliqué the C4 square $11\frac{1}{2}$ " (29.21cm) from the right and $1\frac{3}{4}$ " (4.45cm) from the top edges to complete Unit 14 (27 " x $8\frac{1}{2}$ " (65.58cm x 21.64cm)). (**Fig. 23**)

Fig. 23

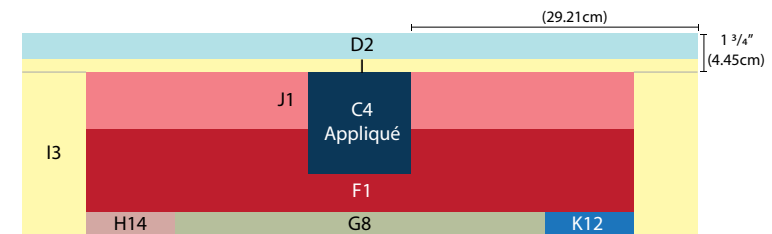

Unit 14
27" wide x $8\frac{1}{2}$ " high
(65.58cm x 21.64cm)

28. Appliqué the D9 square to the remaining F3 square, $2\frac{1}{4}"$ (5.72cm) from the left and $1\frac{1}{2}"$ (3.81cm) from the top. (**Fig. 24**)

Fig. 24

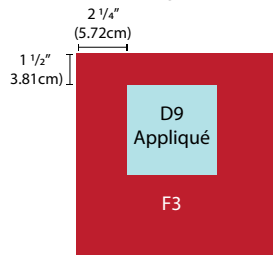

29. Sew an H12 rectangle to the sides of the C3 square. Sew an H11 rectangle to the top and bottom. (**Fig. 25**)

Fig. 25

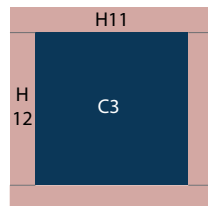

30. Sew the Step 28 unit to the left side of Unit 14 and the Step 29 unit to the right side to complete the Top Panel ($43" \times 8\frac{1}{2}"$ (109.22 x 21.59cm)). (**Fig. 26** shown right)

Quilt Top Assembly

Note: Follow the **Quilt Layout** diagram on page 12 while assembling the quilt.

31. Sew the Right, Center and Left Panels together. Sew the Top Panel to the top. ($43" \times 58\frac{1}{2}"$ (109.22cm x 148.59cm)).
32. Appliqué the remaining (4) squares, shown with yellow outlines, to the Quilt Top as listed below:
- A5 moth square, $5\frac{3}{4}"$ (14.61cm) from the left and $7\frac{1}{4}"$ (18.42cm) from the top edges
 - E5 square, $8\frac{1}{4}"$ (20.96cm) from the right and $7\frac{1}{4}"$ (18.42cm) from the top edges
 - C2 square, $10\frac{3}{8}"$ (26.35cm) from the right and 20" (50.80cm) from the top edges
 - C6 square, $12\frac{3}{4}"$ (32.39cm) from the left and 24" (60.96cm) from the top edges

Embellishments (Optional)

Use embroidery floss or perle cotton to hand sew running stitch, back stitch, and French knots to add detail to the leaves, stems and animals of Fabrics **A** and **B** and highlight the butterflies in Fabrics **E** and **F**.

Finishing

33. Sew together the $2\frac{1}{2}"$ (6.35cm) **Fabric C** binding strips end to end using diagonal seams. Press seams open. Press the binding strip in half wrong sides together.
34. Layer backing (wrong side up), batting, and quilt top (right side up). Baste the layers together and quilt as desired. Trim excess batting and backing even with the top after quilting is completed.
35. Leaving an 8" (20.32cm) tail of binding, sew the binding to the top of the quilt through all layers matching all raw edges. Miter corners. Stop approximately 12" (30.48cm) from where you started. Lay both loose ends of binding flat along quilt edge. Where the loose ends meet, fold them back on themselves and press to form a crease. Using this crease as your stitching line, sew the two open ends of the binding right sides together. Trim seam to $\frac{1}{4}"$ (.64cm) and press open. Finish sewing binding to quilt.
36. Turn the binding to the back of quilt and hand-stitch in place.

Fig. 26

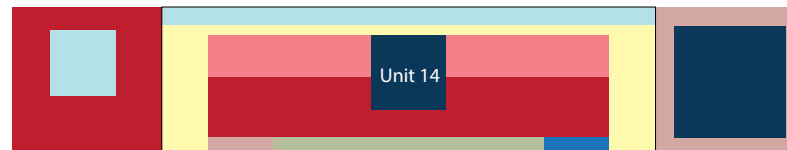

Top Panel
43" wide x $8\frac{1}{2}"$ high
(109.22cm x 21.59cm)

Quilt Layout

